

Hiniker Company
 58766 240th St.
 P.O. Box 3407
 Mankato, MN 56002

VEHICLE INSTALLATION INSTRUCTIONS FOR:
 NISSAN TITAN 4x4: 2004 & NEWER

INSTRUCTION SHEET NO: 25012108

MAY 30, 2006



IMPORTANT: Read the Snowplow Operator's Manual before assembling this kit.

REAR BALLAST - 200 lbs. when plow is attached. Secure Weight Behind Rear Wheels.

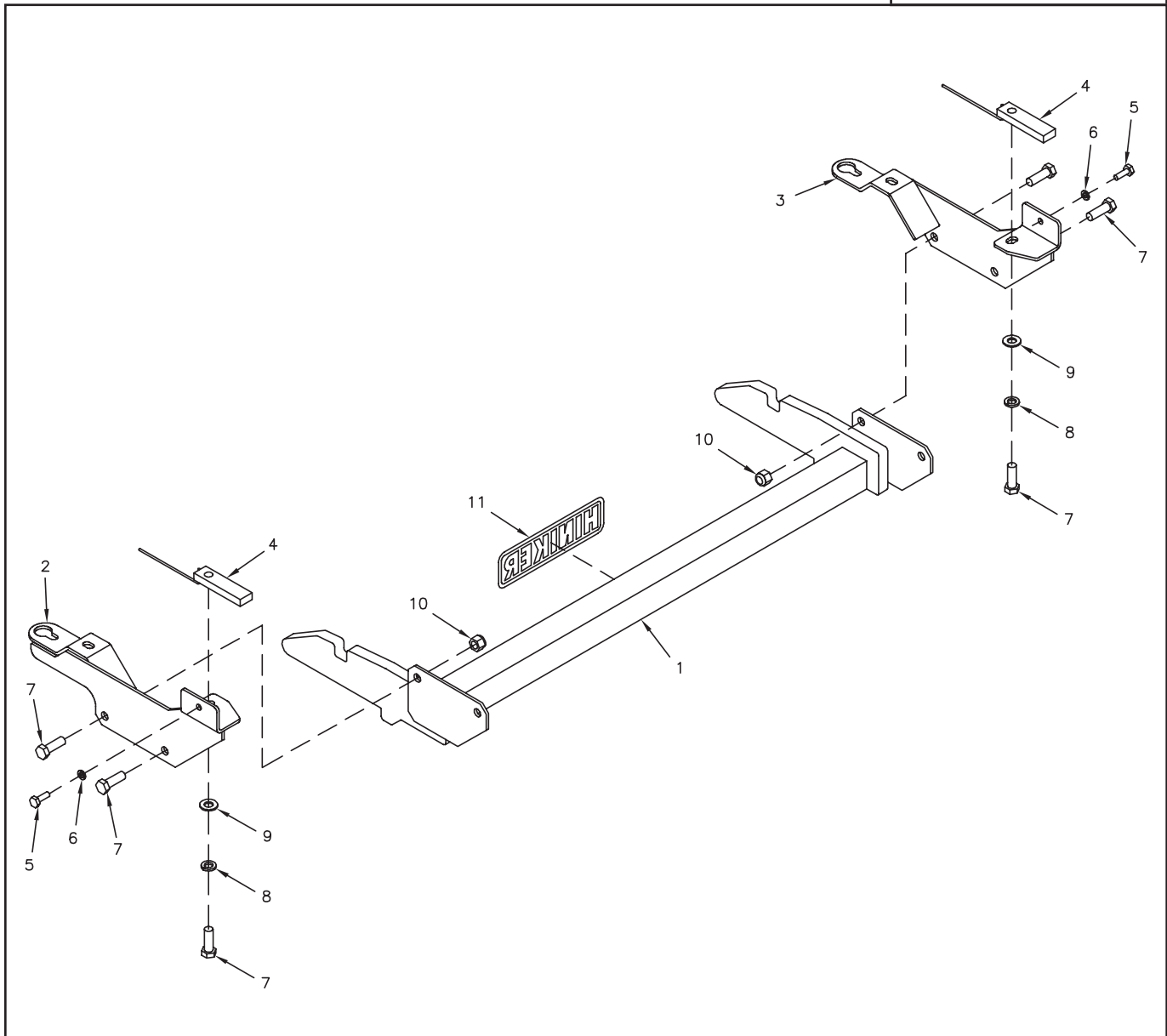

Mount Kit 25012109

DWG. NO. 5858

REF. NO.	PART NUMBER	DESCRIPTION	QTY.	REF. NO.	PART NUMBER	DESCRIPTION	QTY.
1	25012110	Prong Weldment	1	7	950-001-125	Hex Head Cap Screw 1/2-13 x 1 1/2 Gr. 5	6
2	25012111	LH Bracket Weldment	1	8	952-001-004	Lock Washer 1/2 Inch	2
3	25012112	RH Bracket Weldment	1	9	952-003-004	SAE Flat Washer 1/2 Inch	2
4	25012113	Nut Bar Weldment	2	10	951-003-009	Lock Nut 1/2-13 Nylon Insert	4
5	950-011-059	Hex Head Cap Screw M8 x 1.25 x 25 CL. 8.8	2	11	25010008	Hiniker Decal	1
6	952-001-002	Lock Washer 5/16 Inch	2		25012115	Bolt Bag	1

All hardware should be tightened only enough to ensure safety during assembly. Fully tighten all hardware after entire assembly is completed.

GRADE 5 TYPE B & F LOCK NUT TORQUE VALUES

Size	Ft-lbs.	N-m
5/16"	13-18	17-25
3/8"	23-33	31-44
1/2"	58-82	79-112
5/8"	117-165	158-223

GRADE 5 BOLT TORQUE VALUES*

Size	Ft-lbs.	N-m
1/4"	8-12	11-16
3/8"	29-41	39-56
1/2"	73-103	99-140
5/8"	146-206	198-279
* applications without lock nuts		

1. On each side of the vehicle, remove the lower of the two bolts that fasten the bumper braces to the frame rail. These two bolts will be replaced by hardware supplied in the mount kit.

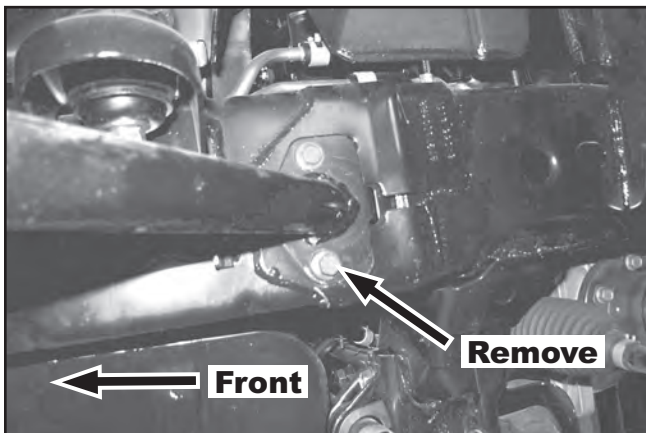

PHOTO NO. DCP0319

Remove the rear bolt fastening each tow hook to the vehicle frame and save the bolts for reinstallation later.

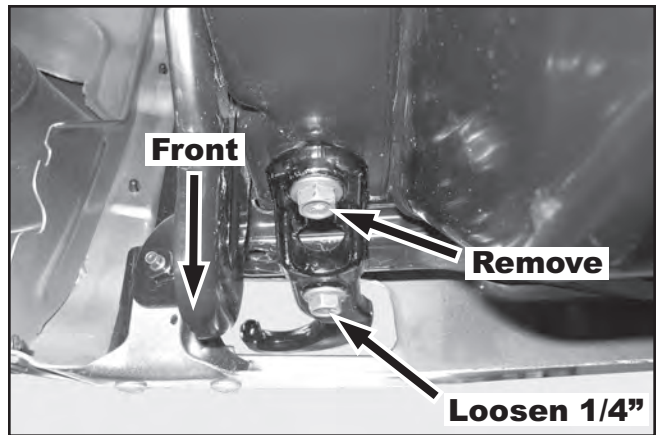

PHOTO NO. DCP0327

Unscrew each front tow hook bolt about 1/4 inch.

2. Insert the two nut bar weldments from the kit through slots in the bottom of each frame rail.

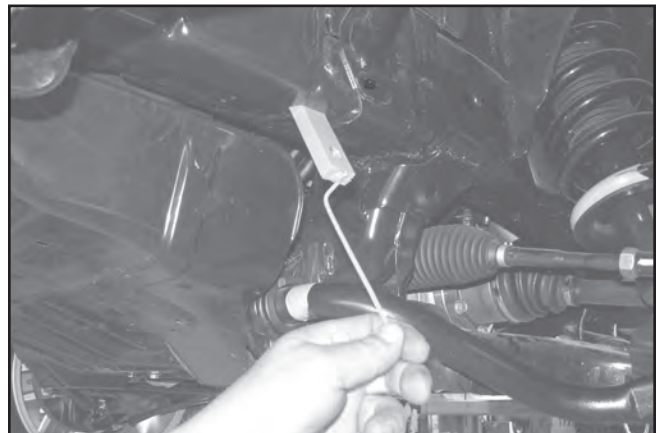

PHOTO NO. DCP0315

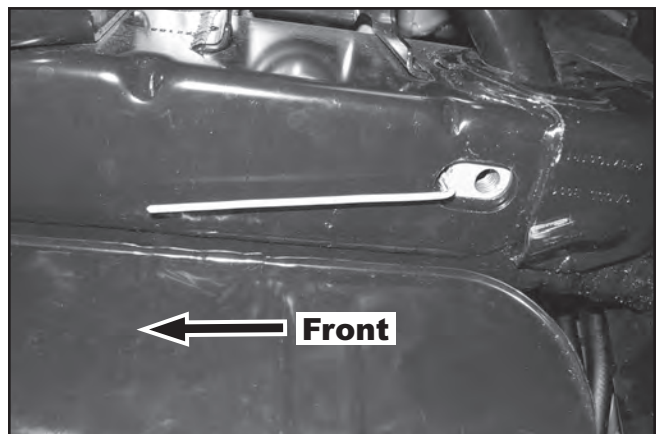

PHOTO NO. DCP0311

Align the nut bars so that the tapped holes are at the rear of the slots and the wire handles are directed forward.

- Carefully lift the LH and RH bracket weldments to the bottom of the frame rails.

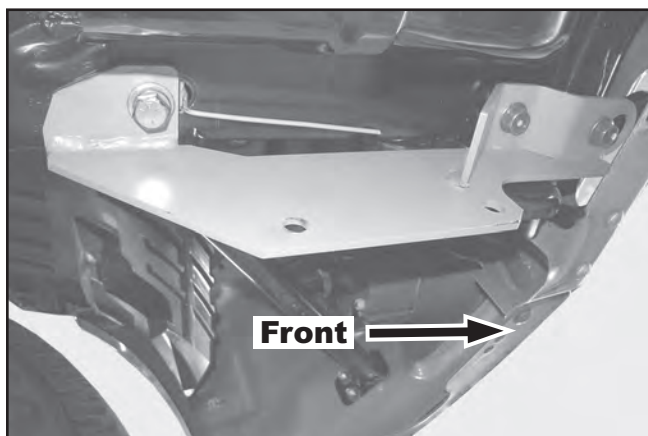

PHOTO NO. DCP0302

Slip the keyhole slot at the front of each bracket over the head of the front tow hook bolt, then slide the bracket forward.

Loosely reinstall the rear tow hook bolts through holes in the brackets to hold the brackets to the truck frame.

Loosely fasten the lower rear hole in each bracket to the nut bars inserted through slots in the frame, using 1/2 inch x 1 1/2 inch hex bolts, lock washer and flat washers.

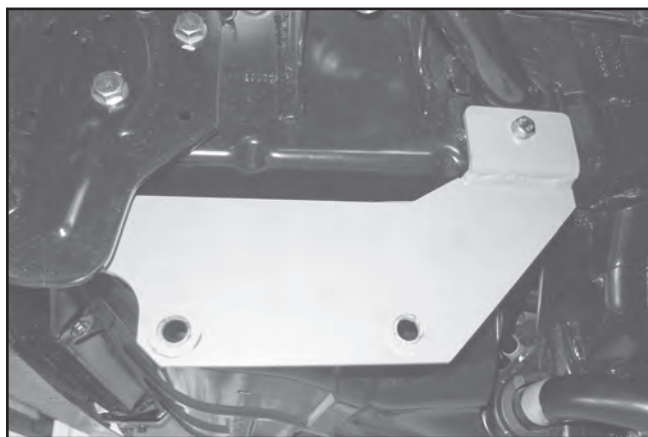

PHOTO NO. DCP0307

Assemble the rear of the brackets to the side of the vehicle frame with 8mm x 25mm hex bolts and 5/16 inch lock washers supplied in the kit.

- Fasten the mount plates of the prong weldment to holes in the side brackets with four 1/2 inch x 1 1/2 inch hex bolts and lock nuts.



PHOTO NO. DCP0298

Bottom edges of the prongs should measure about 10 inches above the ground when completed.

Fully tighten hardware to specified torque values.